

INTERIOR DOOR SYSTEMS

7017 Extruded Aluminum Series

Aluminum Framed Mirror or Glass Bypass Doors



Extruded Aluminum Frame Finishes



ANODIZED ALUMINUM

Glass Options



CLEAR MIRROR
Safety-backed
3mm



SMOKED MIRROR
Safety-backed
3mm



BRONZE MIRROR
Safety-backed
3mm



CLEAR LAMINATED GLASS
6mm



TRANSLUCENT WHITE LAMINATED GLASS
6mm



WHITE BACK PAINTED GLASS
Safety-backed
3mm



RED BACK PAINTED GLASS
Safety-backed
3mm



BLACK BACK PAINTED GLASS
Safety-backed
3mm

Stile Profile

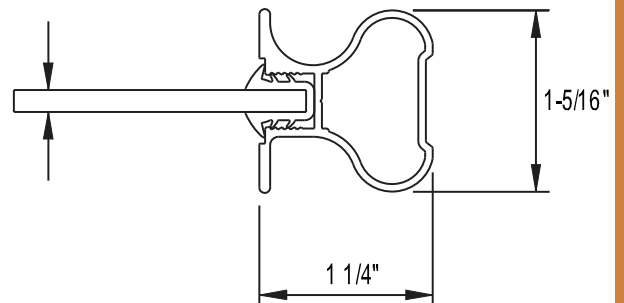
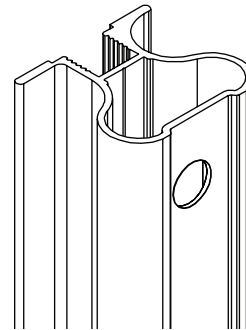

Product Description

- Wide stile extruded aluminum door frame
- Bottom roll system with built in anti-jump feature
- Single or double-sided 3mm mirror glass, back-painted glass or single 6mm laminated glass inserts available (1 Lite white opaque glass shown - single clear mirror glass shown inset)
- Factory finished, ready-to-install
- Custom sizes made to order
- Soft-close mechanism can be purchased pre-installed as added option (P/N BP118)



Featuring



7017 Extruded Aluminum Series Aluminum Framed Mirror or Glass Bypass Doors

Sliding closet doors shall use **7017 Extruded Aluminum Series** hardware consisting of extruded aluminum framed door panels and shall be supported by adjustable bottom rollers that travel in an aluminum bottom track and top guides that travel in an aluminum top track.

The aluminum frame shall consist of stiles (vertical member) with an integral pull and rails (horizontal member).

The stiles and rails shall be fastened at each corner by screws that join the rails to the stiles. Bottom rollers shall have ball bearing wheels with an anti-jump feature. Top guide shall have twin wheels permanently attached to the stile and rail which provides a snug fit with the top track.

The top track shall be one piece and of anodized aluminum. The bottom track shall be anodized aluminum and not exceed 5/16" (8mm) from the floor. Both top track and bottom track finishes shall match the stile and rail. Bottom track is not ADA compliant.

The stile, rail, top track and bottom track shall have anodized (A2) finish. The connectors shall be plated.

Insert thickness: 1/8" or 15/64" (3mm or 6mm)

Maximum single door size: 48" wide x 96" high (1219mm x 2438mm)

Maximum single door weight: 100 lbs. (45kg)

Finished Door Opening Heights: Standard 80 1/2" (door range: 80" to 80 3/4"), standard 96" (door range: 95 1/2" to 96 1/4")

Finished Door Opening Widths: Standard widths of 48", 60", 72", 84", 96", 108", 120", 144", 192". Custom sizes available up to 192"w x 96"h

All JJ® mirror products use safety backed mirror. The mirror conforms to CGSB 12.5-M86 Type 3C (Canada) and ANSI Z97.1-1984 (US)

Cross Sectional

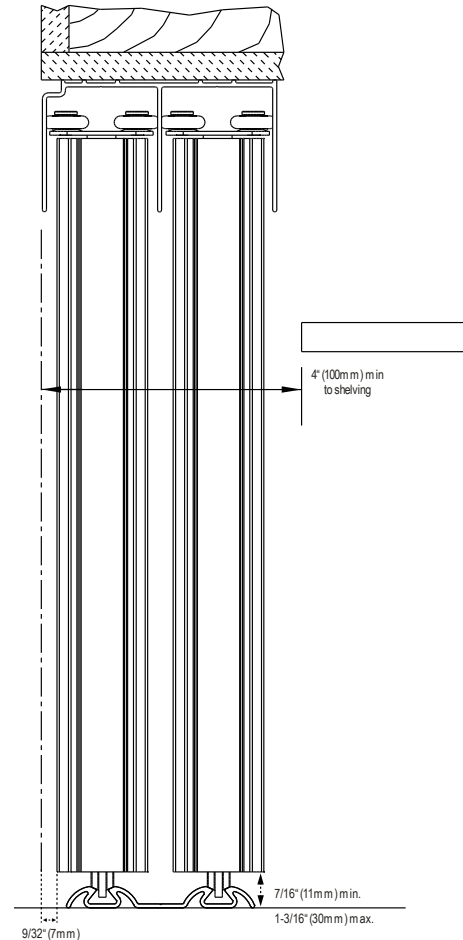

Featuring

